

Connection diagrams

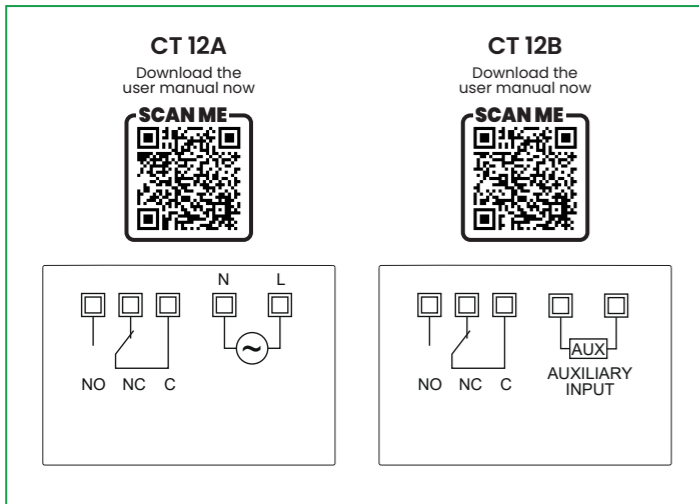

Device dimensions

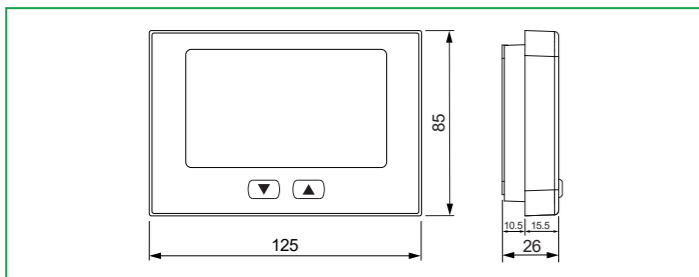

Device description

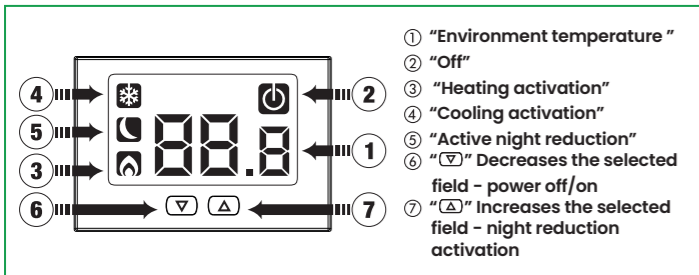

Information to users pursuant to art. 14 of the directive 2012/19 / EU of the European Parliament and of the Council of 4 July 2012 on waste electrical and electronic equipment (WEEE)

If the crossed-out bin symbol appears on the equipment or packaging, this means the product must not be included with other general waste at the end of its working life.

The user must take the worn product to a sorted waste center, or return it to the retailer when purchasing a new one.

Products for disposal can be consigned free of charge (without any new purchase obligation) to retailers with a sales area of at least 400 m², if they measure less than 25 cm.

An efficient sorted waste collection for the environmentally friendly disposal of the used device or its subsequent recycling, helps avoid the potential negative effects on the environment and people's health, and encourages the re-use and/or recycling of the construction materials.

Reference standards

12-2025

Compliance with Community Directives 2014/35/UE (LVD) and 2014/30/UE (EMCD) is declared with reference to the following harmonized standards:
• EN 60730-2-9

V3IS01223-010

User Manual

Read all the instructions carefully

ELECTRONIC WALL THERMOSTATS

Wall-mounted electronic thermostats for temperature control both in heating and cooling. They perform actions of type IB and are intended for operating in environments with Pollution Degree 2 and Overvoltage Category III (EN60730-1).

CT 12A, with mains power supply.
CT 12B, with battery power supply and configurable auxiliary input for the connection of a temperature probe or an external contact with whom to reduce the setpoint of 3°C.

Code	Model	Description
4G001500	CT 12A	230V thermostat
4G001600	CT 12B	Battery thermostat with auxiliary input

SAFETY WARNINGS

During product installation and operation it is necessary to observe the following instructions:

- 1) The device must be installed by a qualified person, in strict compliance with the connection diagrams.
- 2) Do not power or connect the device if any part of it is damaged.
- 3) After installation, inaccessibility to the connection terminals without appropriate tools must be guaranteed.
- 4) The device must be installed and activated in compliance with current electric systems standards.
- 5) Before accessing the connection terminals, verify that the leads are not live.
- 6) In the electrical system of the building where the instrument must be installed, a protection device from the overcurrents must be present (only for CT 12A).

TECHNICAL SPECIFICATIONS

- Power supply CT 12A: - 230 Vac (-15% ÷ +10%) 50/60 Hz
- max absorption: 6 VA / 230 Vac
- Power supply CT 12B: - 2 alkaline batteries 1.5 V (AAA type)
- battery life: 12 months
- depleted batteries indication
- Installation on 3 modules box (503 type)
- Terminals CT 12A:
- 3 terminals for 1.5 mm² for monostable output relay 5 A / 250 Vac
- 2 terminals for 1.5 mm² cables for power supply
- Terminals CT 12B:
- 3 terminals for 1.5 mm² for bistable output relay 5 A / 250 Vac
- 2 terminals for 1.5 mm² cables for digital input (to connect a temperature probe or an external contact to reduce the setpoint by 3 °C)
- Operating mode: summer/winter/off (with antifreeze)
- Password protected lock keypad
- Regulation type:
- on/off with settable differential (0.1 ÷ 1 °C)
- P8 proportional with 0.8 °C band (-0.3 ÷ 0.5 °C) and period 8 minutes
- P15 proportional with 1.5 °C band (-0.7 ÷ 0.8 °C) and period 15 minutes
- Measurement precision: ±0.5 °C
- Measurement temperature resolution: 0.1 °C
- Range setpoint setting: 2 °C ÷ 50 °C
- Operating temperature: 0 °C ÷ 50 °C
- Storage temperature: -10 °C ÷ 65 °C
- Operating humidity: 20÷90% non condensing
- Protection degree: IP40
- Insulation: reinforced among accessible parts (frontal) and all other terminals

Installation

- The device can be installed on the wall or to cover the 3-module flush-mounting box (type 503).
- We recommend positioning at a height of 1.5 meters from the floor, in an area that respects as much as possible the average temperature conditions of the entire environment.
- Avoid installation near doors or windows, in niches, behind doors and curtains or in positions with excess or total lack of ventilation, to avoid that the reading of the temperature measured by the probe is in some way offset.

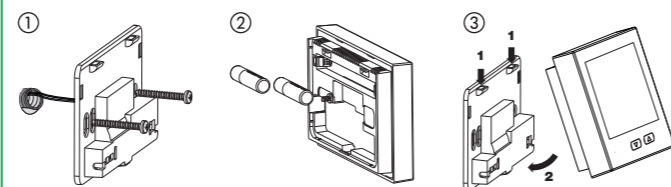

- 1) Connect the cables to the terminal block on the back of the base (see connection diagram) and secure the device to the wall.
- 2) Insert the batteries into the dedicated compartment, observing the correct polarity (only for CT 12B)
- 3) Place the front panel on top of the wall-mounted part, paying particular attention to the correct coupling of the two parts, and close the device by rotating the front panel downwards.

Operation

During normal operation the thermostat displays the measured temperature value and the relay status is identified by the symbol (heating) or by the symbol (cooling).

Setpoint modification

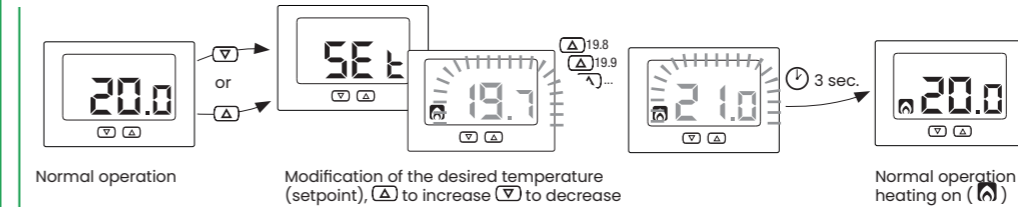

Night reduction

(only for CT 12B)
"Night reduction" function reduces the programmed setpoint by 3 °C. Press for 3 seconds the key to activate (or deactivate, if already active) the night reduction.

When the night reduction is active, the display shows the symbol .

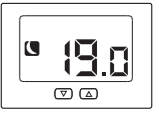

Switch off

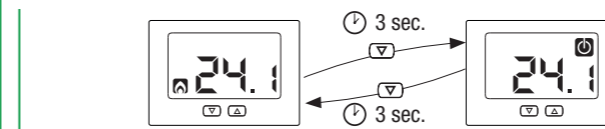

Note: in heating mode (winter), if the Thalos Key is off, it adjusts the antifreeze **Toff** temperature in order to prevent the system freezing. **Toff** can have values from 1 to 50 °C or be excluded; in this case any minimum temperature is guaranteed.

Error messages

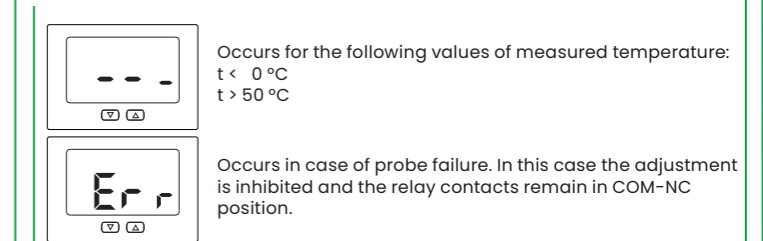

Reset

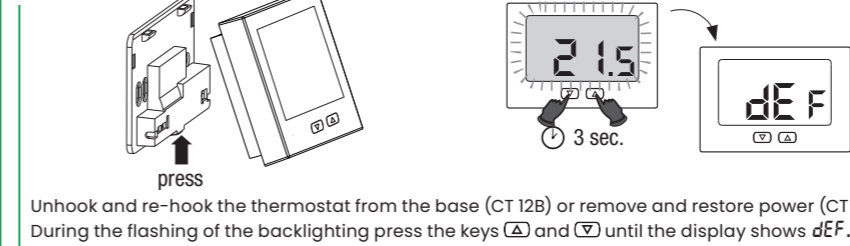

Unhook and re-hook the thermostat from the base (CT 12B) or remove and restore power (CT 12A). During the flashing of the backlighting press the keys and until the display shows **dEF**.

Default values

Heating setpoint	21 °C
Cooling setpoint	25 °C
Minimum settable setpoint - L0	2 °C
Maximum settable setpoint - H1	50 °C
Operating mode	(heating)
Antifreeze temperature	6 °C
Regulation type	On / Off
Differential	0,3 °C
Auxiliary input	DIG
Password	--- (disabled)

Advanced programming

To enter menu Advanced programming keep simultaneously pressed for 5 seconds the keys and until **Pr** will appear. The items of the menu are displayed in succession. For each item is displayed an identity breviation and its relative blinking value. Use the keys and to modify the value. The passage to the next parameter occurs after 3 seconds without pressing any key. The writing **End** will appear when all parameters are set and the thermostat returns to normal operation saving the effected modifications.

- L0** Minimum settable setpoint - **L0**
It's the minimum value settable as setpoint.
Settable values: 2 °C ÷ **H1**
- H1** Maximum settable setpoint - **H1**
It's the maximum value settable as setpoint.
Settable values: **L0** ÷ 50 °C
- E-1** Operating mode - **E-1**
 if connected to the boiler (heating)
 if connected to a cooling system
- 06.0** Antifreeze temperature - **Toff** - (only in heating)
Minimum temperature maintained with device off (see box «Switch off»)
Settable values: 1 ÷ 50 °C or --- (excluded function)
- rE0** Regulation type - **rE0** - (only in heating)
0 = on/off with settable differential
P8 = proportional with band 0.8 °C and period 8 minutes
P15 = proportional with band 1.5 °C and period 15 minutes
- d0.3** Differential - **d0.3** - (only for on/off regulation)
Differential (or hysteresis) for temperature regulation.
Settable values: 0.1 ÷ 1 °C
- Est** Input configuration - **Est** - (only for CT 12B)
- for one temperature probe connection
- **d10** for connecting an external contact to reduce the set temperature. With the external contact closed, the setpoint is reduced by 3 °C compared to the set value and the appears on the display.
- PA5** Password for keypad lock - **PA5**
Set a value between 001 and 999 to activate the keypad lock. Set "---" to disable the lock. If the keypad lock is active, pressing one key, **Loc** appears and the password is required. If it's properly inserted the keypad lock is unlocked for the next 30 seconds.

Backlighting management

- CT 12A**
The CT 12A has a backlighting of blue colour which is on during normal operation.

If the installation makes it necessary (for example bedrooms) you can turn off the backlighting. In this condition the thermostat continues to operate normally and the backlighting turns on when you enter setpoint modification menus, advanced programming, pin entry.

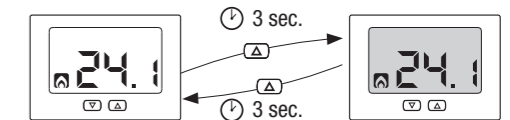

- CT 12B**
The CT 12B has a blue backlight that is normally off and remains on for a few seconds after a button is pressed.

Battery replacement (only for CT 12B)

- In the event of low batteries, the device display will alternately show:

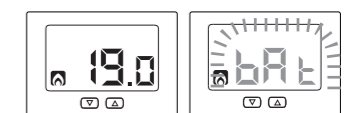

Use only alkaline batteries

- Replace the batteries as soon as possible

It is necessary to remove the batteries before the instrument is scrapped.

In case of replacement, dispose of the batteries in the special containers of separate waste collection.

