

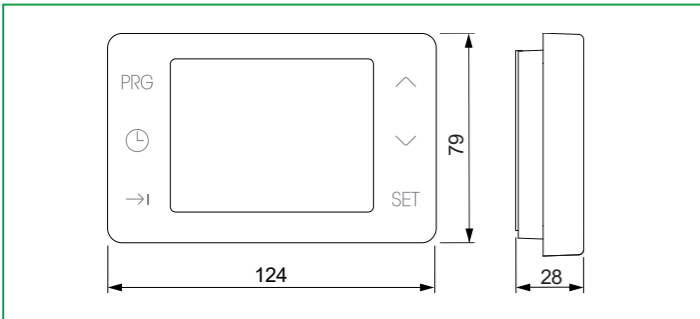

Device dimensions

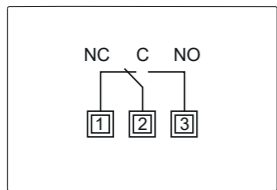

Connection diagrams



The voltage appearing at terminal No. 1, No. 2 or No. 3 depends only on the system being controlled, therefore the dimensions of the wire are determined by the type of the device to be controlled. The length of the wire is irrelevant.

Device description

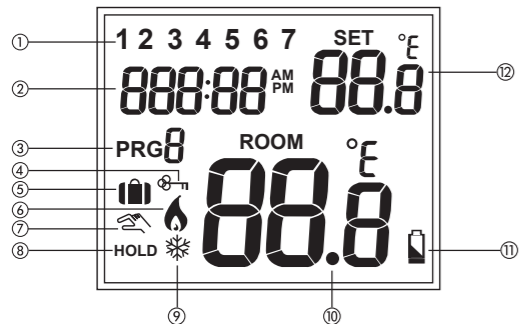

- ① Days of the week
- ② Clock
- ③ Program number
- ④ Keypad lock active
- ⑤ Holidays
- ⑥ Heating mode
- ⑦ Manual control
- ⑧ Permanent operation mode
- ⑨ Air conditioning operation
- ⑩ Measured temperature
- ⑪ Battery status
- ⑫ Set temperature

Information to users pursuant to art. 14 of the directive 2012/19 / EU of the European Parliament and of the Council of 4 July 2012 on waste electrical and electronic equipment (WEEE)

If the crossed-out bin symbol appears on the equipment or packaging, this means the product must not be included with other general waste at the end of its working life.

The user must take the worn product to a sorted waste center, or return it to the retailer when purchasing a new one.

Products for disposal can be consigned free of charge (without any new purchase obligation) to retailers with a sales area of at least 400 m², if they measure less than 25 cm.

An efficient sorted waste collection for the environmentally friendly disposal of the used device or its subsequent recycling, helps avoid the potential negative effects on the environment and people's health, and encourages the re-use and/or recycling of the construction materials.

Reference standards

01-2026

- Compliance with Community Directives 2014/35/UE (LVD) and 2014/30/UE (EMCD) is declared with reference to the following harmonized standards:
 - EN 60730-2-7 • EN 60730-2-9

User Manual

Read all the instructions carefully

DIGITAL THERMOSTAT

Battery-powered wall-mounted chronothermostat, suitable for controlling heating and air conditioning systems. It performs type 1B actions and is designed to operate in environments with pollution level 2 and overvoltage category III (EN 60730-1).

Code	Model	Description
4G001700	CC 15B	Digital thermostat for temperature control

SAFETY WARNINGS

During product installation and operation it is necessary to observe the following instructions:

- 1) The device must be installed by a qualified person, in strict compliance with the connection diagrams.
- 2) Do not power or connect the device if any part of it is damaged.
- 3) After installation, inaccessibility to the connection terminals without appropriate tools must be guaranteed.
- 4) The device must be installed and activated in compliance with current electric systems standards.
- 5) Before accessing the connection terminals, verify that the leads are not live.

TECHNICAL SPECIFICATIONS

- Power supply:
 - 2 alkaline batteries 1.5 V (AA type)
 - battery life: 2 years
 - depleted batteries indication
- Relay rating: 6 A (2 A inductive load), 230 Vac
- Wall installation (or covering the 503 box)
- Operating modes: heating, air conditioning or off
- Programmability: 7-day, 5/2-day and 24-hour modes
- Keypad lock
- Displayable temperature range: 0 °C ÷ 40 °C (in increments of 0.1 °C)
- Setpoint setting range: 5 °C ÷ 35 °C (in increments of 0.5 °C)
- Measurement accuracy: ±1 °C (at 20 °C)
- Backlit display

Installation

- The device can be installed on the wall or to cover the 3-module flush-mounting box (type 503).
- We recommend positioning at a height of 1.5 meters from the floor, in an area that respects as much as possible the average temperature conditions of the entire environment.
- Avoid installation near doors or windows, in niches, behind doors and curtains or in positions with excess or total lack of ventilation, to avoid that the reading of the temperature measured by the probe is in some way offset.

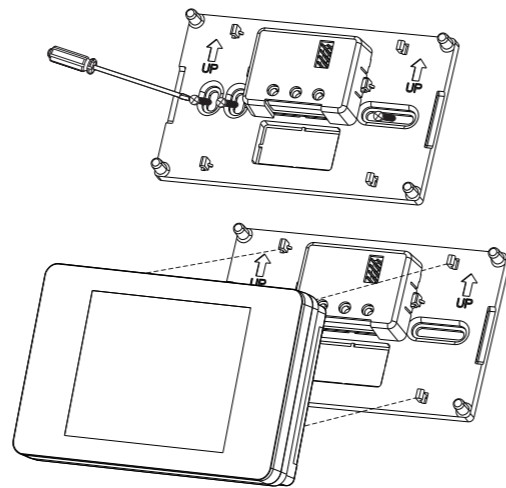

Battery replacement

- The average battery life is 2 year, but the frequent use of the backlight can reduce this time considerably.
- If the icon indicating low battery voltage appears on the display, the batteries must be replaced.

Use only alkaline batteries

- It is necessary to remove the batteries before the instrument is scrapped.
- In case of replacement, dispose of the batteries in the special containers of separate waste collection.

Operation

HOW TO SET THE TIME

- Press the "C" button once until the day of the week number starts flashing, use the "▲" or "▼" buttons to adjust from 1 to 7.
- Press the "→" button once. The hour symbol starts flashing. Use the "▲" or "▼" buttons to adjust from 0 to 23.
- Press the "→" button once. The minute symbol starts flashing. Use the "▲" or "▼" buttons to adjust the minutes from 0 to 59.
- Press the "SET" button to confirm changes or wait for 15 seconds to automatically confirm and return to the Run Mode.

PROGRAM SETUP

- The device allows the configuration of 6 temperature programs (PRG1 ÷ PRG6) to be set according to your needs over a 24-hour period for each day of the week.

The factory settings are:

Days of the week 1 to 5 (Monday - Friday)

PRG1: 06:00 am - 20 °C PRG2: 08:00 am - 15 °C PRG3: 12:00 pm - 15 °C
PRG4: 02:00 pm - 15 °C PRG5: 05:00 pm - 21 °C PRG6: 10:00 pm - 15 °C

Days of the week 6 to 7 (Saturday - Sunday)

PRG1: 07:30 am - 20 °C PRG2: 09:30 am - 20 °C PRG3: 11:30 am - 20 °C
PRG4: 01:30 pm - 20 °C PRG5: 04:30 pm - 21 °C PRG6: 10:30 pm - 15 °C

- If the factory settings don't meet your needs, you can change them as follows:

- Press the "PRG" button once, the day of the week symbol starts flashing (1, 2, 3, 4, 5).
 - Press the "▲" or "▼" buttons to select the desired day of the week or "1 2 3 4 5" and/or "6 7" for the 5/2-day mode, or "1, 2, 3, 4, 5, 6, 7" for the 7-day mode.
 - Press the "→" button once. PRG1 will be displayed and the time will start flashing. Use the "▲" or "▼" buttons to select the time at which to run the PRG1 program (in 10-minute increments).
 - Press the "→" button once; the temperature will start flashing. Use the "▲" or "▼" buttons to adjust the temperature during the PRG1 program (in increments of 0.5°C).
 - Press the "→" button once. PRG2 will be displayed and the time will start flashing. Repeat the steps described above from point 3 for all 6 temperature programs.
 - Once the time and temperature of the 6 programs have been set and the day or days of the week are flashing, press the "→" button again to repeat the steps above from step 2 until all 7 days of the week have been set.
 - Press the "SET" button to confirm the settings or wait 60 seconds for automatic confirmation and return to normal operating mode.
- To view the programming parameters in normal execution mode, press the "PRG" button and use the "▲" or "▼" buttons to move to the different days of the week.

ADVANCED SETTINGS

- The device allows the setting of some technical parameters to optimize its operation.
- Temperature compensation**
 - Press and hold the "SET" button for 5 seconds to access the **operating settings** screen.
 - Press the "→" button to enter the "CAL" temperature calibration interface, the temperature will start flashing.
 - Press the "▲" or "▼" buttons to set the desired value (settable values -3.0 °C ÷ +3.0 °C, in increments of 0.5 °C).
 - Press the "SET" button to confirm.
- Temperature differential**
 - Press and hold the "SET" button for 5 seconds to access the **operating settings** screen.
 - Press the "→" button to enter the "CAL" temperature calibration interface, the temperature will start flashing.
 - Press the "→" button twice to enter the "DIFF" temperature compensation interface, the temperature will start flashing.
 - Press the "▲" or "▼" buttons to set the desired value (settable values 0.2 °C ÷ 2.0 °C, in increments of 0.5 °C).
 - Press the "→" button to exit.

(Example: with a temperature set to 20.0°C and a differential set to 0.3°C, the heating turns on when the room temperature is less than or equal to 19.7°C; when the room temperature is greater than or equal to 20.3°C, the heating turns off.)

OPERATION SETTINGS

- The device can operate in 3 different modes (Heating/Air Conditioning/Off) which can be set, according to your needs, as follows:
 - Press and hold the "SET" button for 5 seconds to enter the selection screen.
 - Press the "▲" or "▼" buttons to select and set "HEAT" (Heating), "COOL" (Conditioning) or "OFF" (Off).
 - Press the "SET" button to confirm.

MANUAL SETTING

- The device allows the configuration of 4 manual modes to be set according to your needs.
 - Temporary manual**
This temperature setting will remain in effect until the next PRG or until the "SET" button is pressed again.
 - Press the "▲" or "▼" buttons to select the desired temperature.
 - Press the "SET" button to confirm the changes or wait 15 seconds for automatic confirmation (the symbol will appear on the screen).
 - Permanent manual**
This temperature setting will remain in effect permanently until the "SET" button is pressed again.
 - Press the "▲" or "▼" buttons to select the desired temperature.
 - Press the "→" button once, "HOLD" will be displayed.
 - Press the "SET" button to confirm the changes or wait 15 seconds for automatic confirmation.
 - Manual timed hours**
This temperature setting will be maintained for the set duration of time in hours or until the "SET" button is pressed again.
 - Press the "▲" or "▼" buttons to select the desired temperature.
 - Press the "→" button 2 times, the "1H" will start flashing.
 - Press the "▲" or "▼" buttons to set the desired hours between 1H and 9H.
 - Press the "SET" button to confirm the changes or wait 15 seconds for automatic confirmation.
 - Timed manual days (holiday)**
This temperature setting will be maintained for the duration of the set number of days or until the "SET" button is pressed again.
 - Press the "▲" or "▼" buttons to select the desired temperature.
 - Press the "→" button 3 times, the "1d" will start flashing.
 - Press the "▲" or "▼" buttons to set the desired days between 1d and 99d.
 - Press the "SET" button to confirm the changes or wait 15 seconds for automatic confirmation.

KEYBOARD LOCK FUNCTION

- Press and hold the "PRG" button for 5 seconds to activate the keyboard lock function. "LOC" appears on the display for 3 seconds and the icon appears. All buttons are then locked and cannot be used.
- Press and hold the "PRG" button for another 5 seconds to unlock the buttons and display "UNLOC" on the screen.

BACKLIGHTING

- The backlight turns on by pressing any button and turns off after 15 seconds of inactivity.

Restoring the thermostat

- Perform a reset to erase your settings and restore the device to its factory defaults.
- To reset:
 - Press and hold the "SET" button for 5 seconds to access the operation settings screen.
 - Press the "→" button to enter the "CAL" temperature calibration interface, the temperature will start flashing.
 - Press the "→" button again to display the "RESET" mode.
 - Press the "PRG" button, the "-----" icon will appear.
 - Press the "PRG" button again.

At this point the display will show all segments, indicating that the thermostat has been successfully reset to factory default settings.